

# FuseMaster NH Fuses

## NH00F/NH000F

500VAC (250VDC)

fast (gG)



DIMENSIONS (mm) REFER TO DIAGRAM BELOW					
AMP	Size	A	B	C	D
<b>4-100</b>	00C	49	78	40	21
<b>125-160</b>	00	49	78	48	30

Class gG for cable and line protection

PART NO.	SIZE	AMP
<b>NH000F-2</b>	00C	2
<b>NH000F-4</b>	00C	4
<b>NH000F-6</b>	00C	6
<b>NH000F-10</b>	00C	10
<b>NH000F-16</b>	00C	16
<b>NH000F-20</b>	00C	20
<b>NH000F-25</b>	00C	25
<b>NH000F-32</b>	00C	32
<b>NH000F-35</b>	00C	35
<b>NH000F-40</b>	00C	40
<b>NH000F-50</b>	00C	50
<b>NH000F-63</b>	00C	63
<b>NH000F-80</b>	00C	80
<b>NH000F-100</b>	00C	100
<b>NH00F-125</b>	00	125
<b>NH00F-160</b>	00	160

FUSE HOLDERS TO SUIT Refer to page 68, 69

## NH1F

500VAC (440VDC)

fast (gG)



DIMENSIONS (mm) REFER TO DIAGRAM BELOW					
AMP	Size	A	B	C	D
<b>16-160</b>	1C	65	135	46	28
<b>200-250</b>	1	65	135	46	46

Class gG for cable and line protection

PART NO.	SIZE	AMP
<b>NH1F-16</b>	1C	16
<b>NH1F-20</b>	1C	20
<b>NH1F-25</b>	1C	25
<b>NH1F-32</b>	1C	32
<b>NH1F-35</b>	1C	35
<b>NH1F-40</b>	1C	40
<b>NH1F-50</b>	1C	50
<b>NH1F-63</b>	1C	63
<b>NH1F-80</b>	1C	80
<b>NH1F-100</b>	1C	100
<b>NH1F-125</b>	1C	125
<b>NH1F-160</b>	1C	160
<b>NH1F-200</b>	1	200
<b>NH1F-224</b>	1	224
<b>NH1F-250</b>	1	250

FUSE HOLDERS TO SUIT Refer to page 68, 69

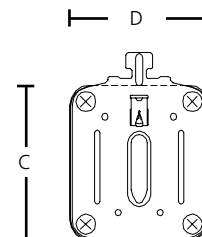
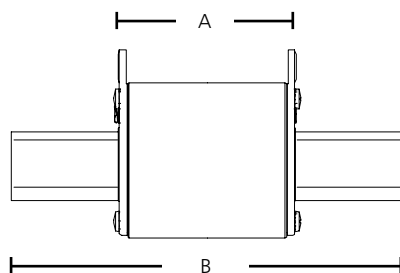

# FuseMaster NH Fuses

## NH2F

500VAC (440VDC)  
fast (gG)

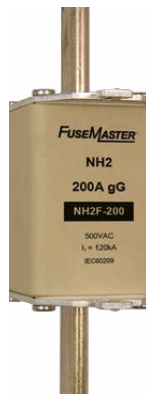

FuseMASTER

Class gG for cable and line protection

PART NO.	SIZE	AMP
NH2F-35	2CC	35
NH2F-40	2CC	40
NH2F-50	2CC	50
NH2F-63	2CC	63
NH2F-80	2CC	80
NH2F-100	2CC	100
NH2F-125	2CC	125
NH2F-160	2CC	160
NH2F-200	2C	200
NH2F-224	2C	224
NH2F-250	2C	250
NH2F-300	2	300
NH2F-315	2	315
NH2F-355	2	355
NH2F-400	2	400

DIMENSIONS (mm) REFER TO DIAGRAM BELOW

AMP	Size	A	B	C	D
35-160	2CC	65	150	46	28
200-250	2C	65	150	47.5	47.5
300-400	2	65	150	56	56.5

FUSE HOLDERS TO SUIT Refer to page 68, 69

## NH3F

500VAC (440VDC)  
fast (gG)



FuseMASTER

Class gG for cable and line protection

PART NO.	SIZE	AMP
NH3F-315	3C	315
NH3F-355	3C	355
NH3F-400	3C	400
NH3F-425	3	425
NH3F-500	3	500
NH3F-630	3	630

DIMENSIONS (mm) REFER TO DIAGRAM BELOW

AMP	Size	A	B	C	D
315-400	3C	68	150	56.5	57
425-630	3	68	150	66.5	67

FUSE HOLDERS TO SUIT Refer to page 68, 69

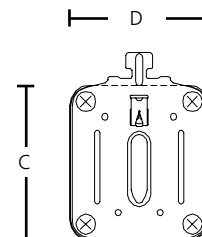
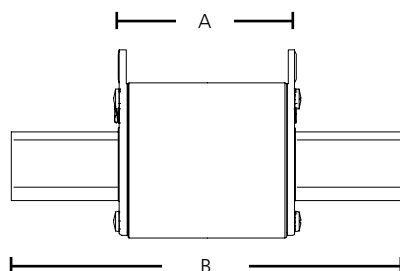

# Size 00/000

FUSE HOLDERS TO SUIT Refer to pages 68, 69

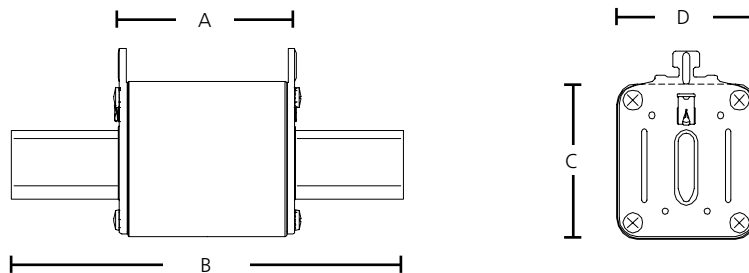

## 200013 / 2000113 500VAC (220VDC) fast (gG)



Class gG for cable and line protection

DIMENSIONS (mm) REFER TO DIAGRAM ABOVE						
PART NO.	AMPS	SIZE	A	B	C	D
2000013	2-100	000	47	78	40.5	20.5
2000113	125-160	00	47	78	46	29.5

PART NO.	AMP	PART NO.	AMP
2000013-2	2A	2000013-35	35A
2000013-4	4A	2000013-40	40A
2000013-6	6A	2000013-50	50A
2000013-10	10A	2000013-63	63A
2000013-16	16A	2000013-80	80A
2000013-20	20A	2000013-100	100A
2000013-25	25A	2000113-125	125A
2000013-32	32A	2000113-160	160A
2000013-35	35A		

## 2047713 / 2020913 690VAC (220VDC) fast (gG)



Class gG for cable and line protection

DIMENSIONS (mm) REFER TO DIAGRAM ABOVE						
PART NO.	AMPS	SIZE	A	B	C	D
2047713	6-50	000	47	78	40.5	20.5
2020913	63-125	00	47	78	46	29.5

PART NO.	AMP	PART NO.	AMP
2047713-6	6A	2047713-40	40A
2047713-10	10A	2047713-50	50A
2047713-16	16A	2020913-63	63A
2047713-20	20A	2020913-80	80A
2047713-25	25A	2020913-100	100A
2047713-32	32A	2020913-125	125A
2047713-35	35A		

## 2047708 / 2020908 690VAC slow (aM)



Class aM for motor applications and other circuits with high inrush currents

DIMENSIONS (mm) REFER TO DIAGRAM ABOVE						
PART NO.	AMPS	SIZE	A	B	C	D
2047708	2-50	000	47	78	40.5	20.5
2020908	63-160	00	47	78	46	29.5

PART NO.	AMP	PART NO.	AMP
2047708-2	2A	2047708-35	35A
2047708-4	4A	2047708-40	40A
2047708-6	6A	2047708-50	50A
2047708-10	10A	2020908-63	63A
2047708-16	16A	2020908-80	80A
2047708-20	20A	2020908-100	100A
2047708-25	25A	2020908-125	125A
2047708-32	32A	2020908-160	160A

## ULTRA RAPID FUSES 690VAC gR/aR



Class gR and aR for the protection of semiconductors

PERFORMANCE	AMP
gR	10A - 100A
aR	125A - 315A

DIMENSIONS (mm) REFER TO DIAGRAM ABOVE						
PART NO.	AMPS	SIZE	A	B	C	D
2047720	6-50	000	47	78	40.5	20.5
2020920	63-160	00	47	78	46	29.5
170M...	200-315	00/000	49	79	40.5	20.5

10-100A class gR / 125-315A class aR

PART NO.	AMP	TOTAL I <sup>2</sup> t @ 690V (A <sup>2</sup> s)	PART NO.	AMP	TOTAL I <sup>2</sup> t @ 690V (A <sup>2</sup> s)
2047720-10	10A	18	2020920-63	63A	1400
2047720-16	16A	40	2020920-80	80A	2600
2047720-20	20A	91	2020920-100	100A	4500
2047720-25	25A	90	2020920-125	125A	9100
2047720-32	32A	330	2020920-160	160A	15000
2047720-35	35A	380	170M1570	200A	28000
2047720-40	40A	450	170M1571	250A	51500
2047720-50	50A	820	170M1572	315A	80500

Size 1

FUSE HOLDERS TO SUIT Refer to pages 68, 69

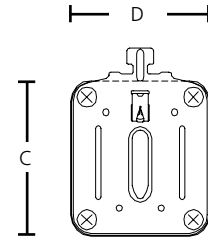
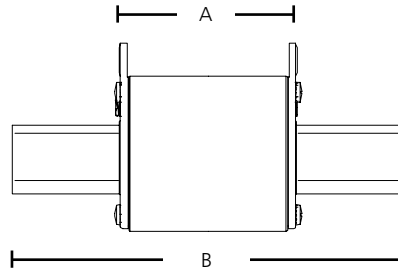

2000313

500VAC (440VDC)  
fast (gG)



Class gG for cable and line protection

DIMENSIONS (mm) REFER TO DIAGRAM ABOVE						
PART NO.	AMPS	SIZE	A	B	C	D
2000313	16-160	1	65	135	46	29.5
2000313	200-315	1	65	135	51.5	42

PART NO.	AMP	PART NO.	AMP
2000313-16	16A	2000313-100	100A
2000313-20	20A	2000313-125	125A
2000313-25	25A	2000313-160	160A
2000313-35	35A	2000313-200	200A
2000313-40	40A	2000313-224	224A
2000313-50	50A	2000313-250	250A
2000313-63	63A	2000313-315	315A
2000313-80	80A		

2021113

690VAC (440VDC)  
fast (gG)



Class gG for cable and line protection

DIMENSIONS (mm) REFER TO DIAGRAM ABOVE						
PART NO.	AMPS	SIZE	A	B	C	D
2021113	16-250	1	65	135	51.5	42

PART NO.	AMP	PART NO.	AMP
2021113-16	16A	2021113-63	63A
2021113-20	20A	2021113-80	80A
2021113-25	25A	2021113-100	100A
2021113-32	32A	2021113-125	125A
2021113-35	35A	2021113-160	160A
2021113-40	40A	2021113-200	200A
2021113-50	50A	2021113-250	250A

2021108

690VAC  
slow (aM)



Class aM for motor applications and other circuits with high inrush currents

DIMENSIONS (mm) REFER TO DIAGRAM ABOVE						
PART NO.	AMPS	SIZE	A	B	C	D
2021108	16-250	1	65	135	51.5	42

PART NO.	AMP	PART NO.	AMP
2021108-16	16A	2021108-80	80A
2021108-20	20A	2021108-100	100A
2021108-25	25A	2021108-125	125A
2021108-35	35A	2021108-160	160A
2021108-40	40A	2021108-200	200A
2021108-50	50A	2021108-224	224A
2021108-63	63A	2021108-250	250A

ULTRA RAPID FUSES

690VAC  
gR/aR



Class gR and aR for the protection of semiconductors

PERFORMANCE	AMP
gR	16A - 100A
aR	125A - 400A

DIMENSIONS (mm) REFER TO DIAGRAM ABOVE						
PART NO.	AMPS	SIZE	A	B	C	D
2021120	16-315	1	65	135	51.5	42
170M....	350-400	1	69	135	43	45

PART NO.	AMP	TOTAL I <sup>2</sup> t @ 690V (A <sup>2</sup> s)	PART NO.	AMP	TOTAL I <sup>2</sup> t @ 690V (A <sup>2</sup> s)
2021120-16	16A	Contact Fuseco	2021120-100	100A	4700
2021120-20	20A		2021120-125	125A	7600
2021120-25	25A		2021120-160	160A	14000
2021120-32	32A		2021120-200	200A	21000
2021120-40	40A		570	2021120-250	250A
2021120-50	50A	1000	2021120-315	315A	76000
2021120-63	63A	1800	170M3818	355A	68500
2021120-80	80A	3400	170M3819	400A	105000

# Size 2

FUSE HOLDERS TO SUIT Refer to pages 68, 69

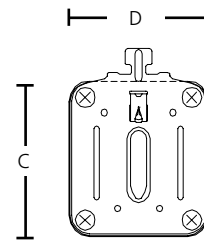
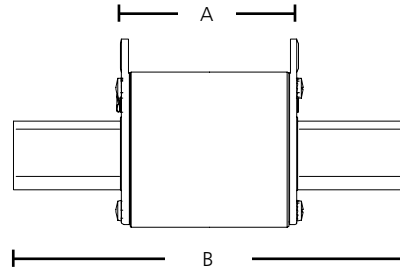

## 2000413 500VAC (440VDC) fast (gG)



Class gG for cable and line protection

DIMENSIONS (mm) REFER TO DIAGRAM ABOVE						
PART NO.	AMPS	SIZE	A	B	C	D
2000413	35-160	2	65	150	46	29.5
2000413	200-250	2	65	150	51.5	42
2000413	300-400	2	65	150	59	53

PART NO.	AMP	PART NO.	AMP
2000413-35	35A	2000413-200	200A
2000413-40	40A	2000413-224	224A
2000413-50	50A	2000413-250	250A
2000413-63	63A	2000413-300	300A
2000413-80	80A	2000413-315	315A
2000413-100	100A	2000413-355	355A
2000413-125	125A	2000413-400	400A
2000413-160	160A		

## 2021213 690VAC (440VDC) fast (gG)



Class gG for cable and line protection

DIMENSIONS (mm) REFER TO DIAGRAM ABOVE						
PART NO.	AMPS	SIZE	A	B	C	D
2021213	35-200	2	65	150	51.5	42
2021213	224-400	2	65	150	59	53

PART NO.	AMP	PART NO.	AMP
2021213-35	35A	2021213-200	200A
2021213-40	40A	2021213-224	224A
2021213-50	50A	2021213-250	250A
2021213-63	63A	2021213-300	300A
2021213-80	80A	2021213-315	315A
2021213-100	100A	2021213-355	355A
2021213-125	125A	2021213-400	400A
2021213-160	160A		

## 2021208 690VAC slow (aM)



Class aM for motor applications and other circuits with high inrush currents

DIMENSIONS (mm) REFER TO DIAGRAM ABOVE						
PART NO.	AMPS	SIZE	A	B	C	D
2021208	35-200	2	65	150	51.5	42
2021208	250-400	2	65	150	59	53

PART NO.	AMP	PART NO.	AMP
2021208-35	35A	2021208-160	160A
2021208-50	50A	2021208-200	200A
2021208-63	63A	2021208-250	250A
2021208-80	80A	2021208-315	315A
2021208-100	100A	2021208-355	355A
2021208-125	125A	2021208-400	400A

## ULTRA RAPID FUSES 690VAC (aR)



Class aR for the protection of semiconductors

DIMENSIONS (mm) REFER TO DIAGRAM ABOVE						
PART NO.	AMPS	SIZE	A	B	C	D
2021220	80-250	2	65	150	51.5	42
2021220	315-450	2	65	150	59	53
170M...	500-700	2	69	150	59	55

16-100A class gR / 125-400A class aR

PART NO.	AMP	TOTAL I <sup>2</sup> t @ 690V (A <sup>2</sup> s)	PART NO.	AMP	TOTAL I <sup>2</sup> t @ 690V (A <sup>2</sup> s)
2021220-80	80A	Contact Fuseco	2021220-350	350A	100000
2021220-100	100A		2021220-400	400A	145000
2021220-125	125A		2021220-450	450A	220000
2021220-160	160A	14000	170M5810	500A	145000
2021220-200	200A	21000	170M5811	550A	190000
2021220-250	250A	63000	170M5812	630A	275000
2021220-315	315A	76000	170M5813	700A	405000

Size 3

FUSE HOLDERS TO SUIT Refer to pages 68, 69

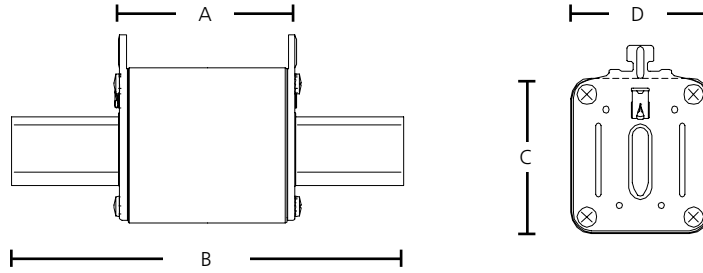

**2000513**  
500VAC (400VDC)  
fast (gG)



Class gG for cable and line protection

DIMENSIONS (mm) REFER TO DIAGRAM ABOVE						
PART NO.	AMPS	SIZE	A	B	C	D
2000513	315-400	3	65	150	59	53
2000513	425-630	3	65	150	73.5	65

PART NO.	AMP	PART NO.	AMP
2000513-315	315A	2000513-450	450A
2000513-355	355A	2000513-500	500A
2000513-400	400A	2000513-630	630A
2000513-425	425A	V228523	800A

**2021313**  
690VAC (440VDC)  
fast (gG)



Class gG for cable and line protection

DIMENSIONS (mm) REFER TO DIAGRAM ABOVE						
PART NO.	AMPS	SIZE	A	B	C	D
2021313	300-315	3	65	150	59	53
2021313	355-425	3	65	150	73.5	65
2021313	500-630	3	65	150	73	73

PART NO.	AMP	PART NO.	AMP
2021313-300	300A	2021313-425	425A
2021313-315	315A	2021313-500	500A
2021313-355	355A	2021313-630	630A
2021313-400	400A		

**2021308**  
690VAC  
slow (aM)



Class aM for motor applications and other circuits with high inrush currents

DIMENSIONS (mm) REFER TO DIAGRAM ABOVE						
PART NO.	AMPS	SIZE	A	B	C	D
2021308	315	3	65	150	59	53
2021308	400	3	65	150	73.5	65
2021308	500-630	3	65	150	73	73

PART NO.	AMP
2021308-315	315A
2021308-400	400A
2021308-500	500A
2021308-630	630A

**ULTRA RAPID FUSES**  
690VAC (aR)



Class aR for the protection of semiconductors

DIMENSIONS (mm) REFER TO DIAGRAM ABOVE						
PART NO.	AMPS	SIZE	A	B	C	D
2021320	315-400	3	65	150	59	53
2021320	450-710	3	65	150	73.5	65
2021320	800	3	68	150	74	76
170M...	900-1000	3	68	150	74	76

PART NO.	AMP	TOTAL I <sup>2</sup> t @ 690V (A <sup>2</sup> s)	PART NO.	AMP	TOTAL I <sup>2</sup> t @ 690V (A <sup>2</sup> s)
2021320-250	250A	-	2021320-550	550A	400000
2021320-315	315A	76000	2021320-630	630A	490000
2021320-350	350A	100000	2021320-710	710A	610000
2021320-400	400A	150000	2021320-800	800A	1050000
2021320-450	450A	220000	170M6813	900A	670000
2021320-500	500A	300000	170M6814	1000A	945000

# Size 4 & 4A



Size 4A



### Size 4A (Blade)

PART NO.	VOLTAGE	AMP	PERFORMANCE	A	B	C	D	E
2012013	500V	400-1600	gG	87	200	110	102	-
2022713	690V	400-800	gG	87	200	110	102	-
2022708	690V	400-1000	aM	87	200	110	102	-



Size 4

### Size 4 (Slotted Blade)

PART NO.	VOLTAGE	AMP	PERFORMANCE	A	B	C	D	E
2000613	500V	400-1250	gG	65	200	110	102	150
2022813	500V	1600	gG	87	200	110	102	150
2022513	690V	400-800	gG	65	200	110	102	150
2022508	690V	400-1000	aM	65	200	110	102	150

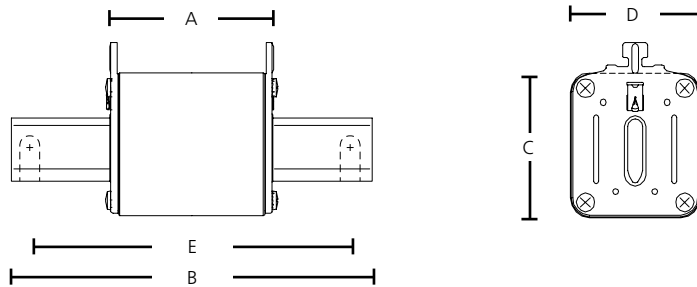

# NH Open Fuse Base



Single pole



Single pole with shrouds & cover



Triple pole



Triple pole with shrouds & cover



PART NO.	NH SIZE	AMP	VOLTAGE
<b>Single Pole</b>			
352100-1	00/000	160A	690V
352250-1	1	250A	690V
352400-1	2	400A	690V
352630-1	3	630A	690V
<b>Single Pole with Shrouds &amp; Cover</b>			
352100-1SC	00/000	160A	690V
352250-1SC	1	250A	690V
352400-1SC	2	400A	690V
352630-1SC	3	630A	690V
<b>Triple Pole</b>			
352100-3	00/000	160A	690V
352250-3	1	250A	690V
352400-3	2	400A	690V
352630-3	3	630A	690V
<b>Triple Pole with Shrouds &amp; Cover</b>			
352100-3SC	00/000	160A	690V
352250-3SC	1	250A	690V
352400-3SC	2	400A	690V
352630-3SC	3	630A	690V

# NH Fuse Disconnect Switches

690VAC

FUSEMASTER



PART NO.	TO SUIT FUSE SIZE	POLE	DESCRIPTION	PACK QTY
NH00-3DS	00/000	3	Triple Pole 160A Disconnect Switch	1
NH1-3DS	1	3	Triple Pole 250A Disconnect Switch	1
NH2-3DS	2	3	Triple Pole 400A Disconnect Switch	1
NH3-3DS	3	3	Triple Pole 630A Disconnect Switch	1

## Note For Semiconductor (Ultra Rapid) Fuses

Watts loss values of fuse and fuse holder combined must be considered if intending to use semiconductor fuses in these enclosed holders. Contact Fuseco for further advice.

# NH Fuse Accessories

GRIP HANDLES **SIBA**



PART NO.	DESCRIPTION	SIZE	VOLTAGE	PACK SIZE
2200102	Grip Handle	00-3	690V	1
2200105	Protected Grip Tool	00-3	690V	1
2203101	Grip Handle	3	1500V	1
2212001	Grip Handle	4-4a	690V	1

# NH NEUTRAL LINKS



SIZE	SIBA PART NO.	FUSEMASTER PART NO.	AMP RATING	VOLTAGE	PACK SIZE
	<b>SIBA</b>	<b>FUSEMASTER</b>			
00	2400102	NH00-NL	160A	690V	10
0	2400202	-	160A	690V	10
1	2400302	NH1NL	250A	690V	10
2	2400402	NH2-NL	400A	690V	10
3	2400502	NH3-NL	630A	690V	10
4	2400602	-	1250A	690V	10
4a	2400607	-	1250A	690V	10